

Features

- 4 PIN diodes in a SOT-25 Plastic Package
- Externally Selectable Bias and RF Matching Network
- 5 - 3000 MHz Useable Frequency Band
- 45 dBm IIP3 @ 1 GHz (50 Ω)
- 2.8 dB Loss @ 1 GHz (50 Ω)
- 36 dB Attenuation @ 1 GHz (50 Ω)
- Lead-Free SOT-25 Package
- RoHS* Compliant

Description and Applications

The MADP-007167-12250T is a wideband, moderate insertion loss, high IP3, PIN diode quad diode in a low-cost, surface mount SOT-25 package. Four PIN Diodes in one package reduce circuit parasitics and improve circuit density.

These PIN diode attenuators perform well where variable RF amplitude control is required in 50 Ω and 75 Ω circuit applications.

Wideband attenuation range, frequency flatness, and input IP3 make these devices suitable for better power level control in RF amplifiers.

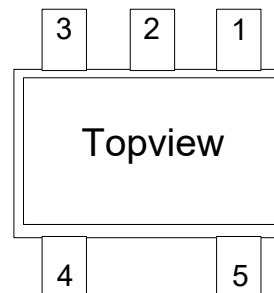

Pin Configuration²

Pin #	Function
1	RF Input
2	Series Bias
3	RF Output
4	Shunt 1 Bias
5	Shunt 2 Bias

2. RF input and RF output are functionally symmetrical.

Ordering Information¹

Part Number	Package
MADP-007167-12250T	3000 piece reel

1. Reference Application Note M513 for reel size information.

Functional Schematic

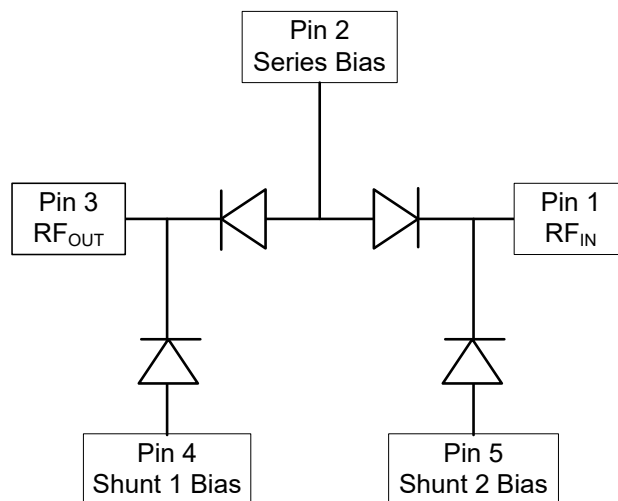

* Restrictions on Hazardous Substances, compliant to current RoHS EU directive.

Electrical Specifications @ +25°C

Parameter	Condition	Unit	Typ.	Max.
Reverse Current (I_R)	$V_R = 200\text{ V}$	μA	—	10
Capacitance (C_T)	$F = 1\text{ MHz}, V = 50\text{ V}$	pF	0.20	0.30
Resistance (R_S)	$F = 100\text{ MHz}, I = 1\text{ mA}$ $F = 100\text{ MHz}, I = 10\text{ mA}$ $F = 100\text{ MHz}, I = 100\text{ mA}$	Ω	85 11 3	— 16 —
Minority Carrier Lifetime (T_L)	$I_F = 10\text{ mA}$	μs	2.7	—
I Region Width	—	μm	175	—

Typical 50 Ω SOT-25 RF Performance: Freq. = 50 - 3000 MHz, $T_A = +25^\circ\text{C}$ using Wide Band RF Circuit Design (Values Shown include Through Loss Calibrated Out of RF Test Circuit)

Parameter	Test Conditions	Units	Typ.
Insertion Loss	13 mA / Series Diode and 3.7 V Shunt 1 and 2 Bias, $F = 1\text{ GHz}$	dB	-2.8
Return Loss	13 mA / Series Diode and 3.7 V Shunt 1 and 2 Bias, $F = 1\text{ GHz}$	dB	-15
Attenuation	0 mA / Series Diode and 3.7 V Shunt 1 and 2 Bias, $F = 1\text{ GHz}$	dB	-36
Input IP3	0 V / Series Diode and 3.7 V Shunt 1 and 2 Bias, $F_1 = 1010\text{ MHz}, F_2 = 1020\text{ MHz}$	dBm	45
Input IP3	+10 V / Series Diode and 3.7 V Shunt 1 and 2 Bias, $F_1 = 1010\text{ MHz}, F_2 = 1020\text{ MHz}$	dBm	43.5
Input IP3	0 V / Series Diode and 3.7 V Shunt 1 and 2 Bias, $F_1 = 110\text{ MHz}, F_2 = 120\text{ MHz}$	dBm	43.5
Input IP3	+10 V / Series Diode and 3.7 V Shunt 1 and 2 Bias, $F_1 = 110\text{ MHz}, F_2 = 120\text{ MHz}$	dBm	39
Settling Time	Within 1 dB of Final Attenuation Value, $F = 1\text{ GHz}$	μs	10
RF CW Incident Power	0 - 20 V Series Diode Bias and 3.7 V Shunt 1 and 2 Bias	dBm	+ 20

Absolute Maximum Ratings @ +25°C³

Parameter	Absolute Maximum
Operating Temperature	-65°C to +125°C
Storage Temperature (0 mW Dissipated Power)	-65°C to +150°C
Junction Temperature	+175°C
DC Voltage @ Temperature Extremes	-200 V
DC Current per diode	200 mA
Mounting Temperature	+235°C for 10 seconds

3. Exceeding these limits may cause permanent damage.

Typical Diode Performance Curves

Series Resistance

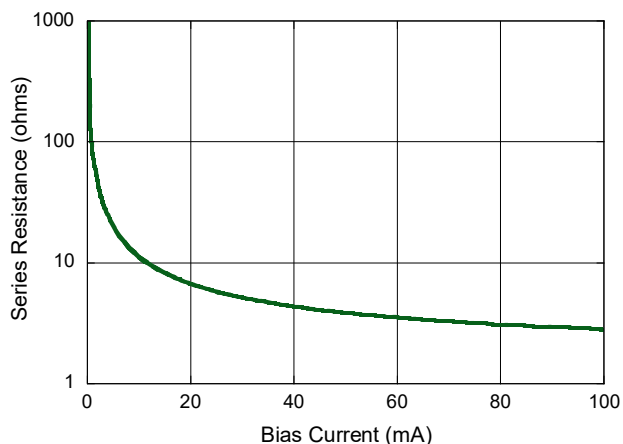

Total Capacitance

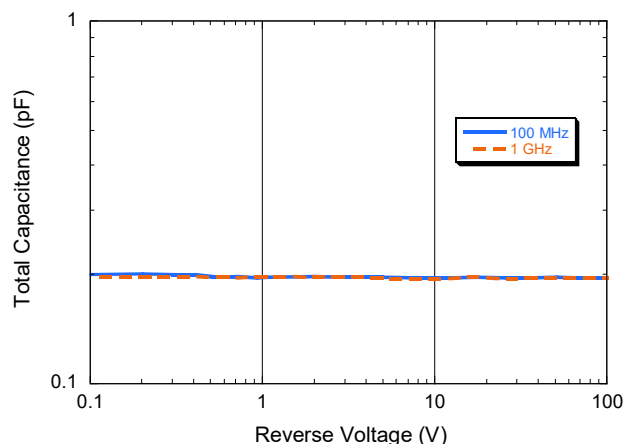

Typical Attenuator Performance

Attenuation

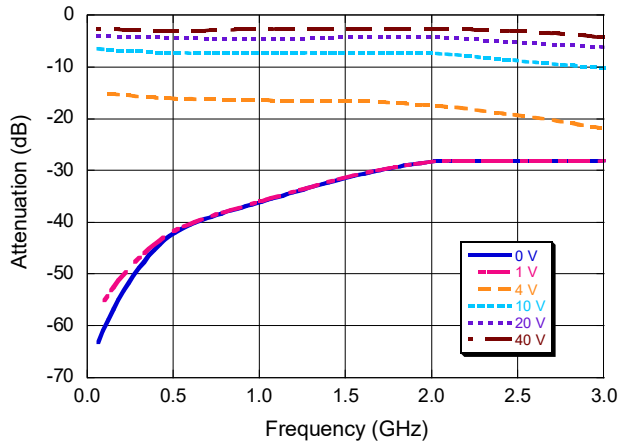

Attenuation Flatness

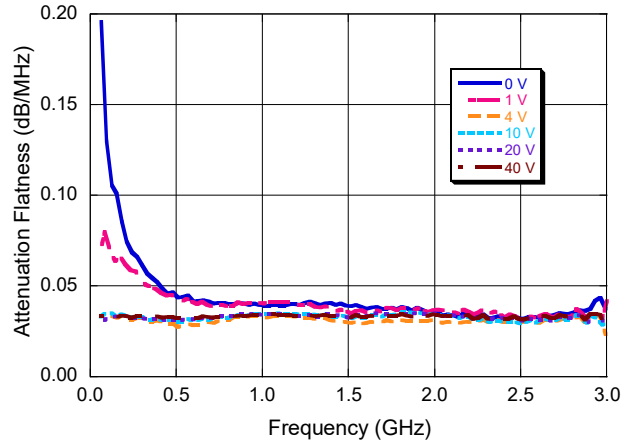

Input IP3

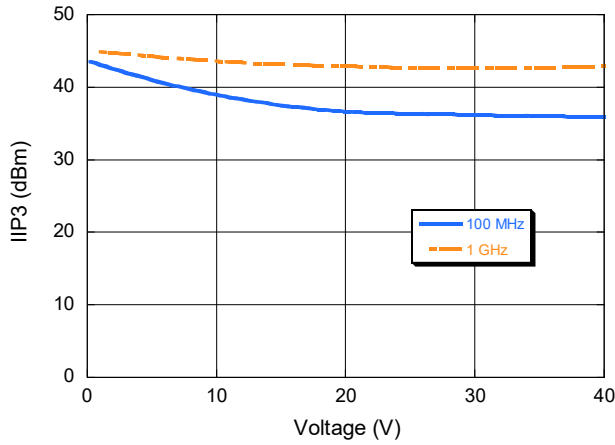

Return Loss

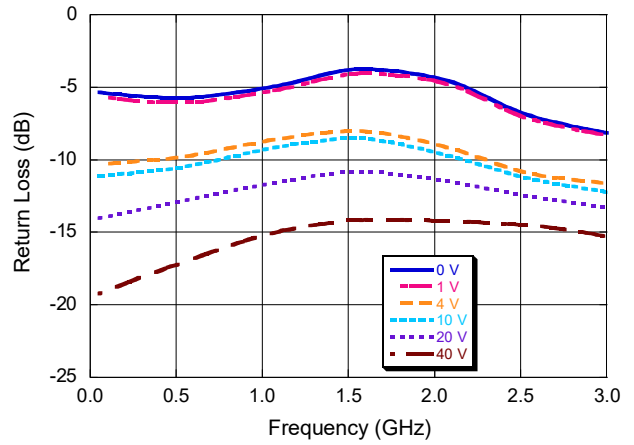

SOT-25 (Case Style 1225)

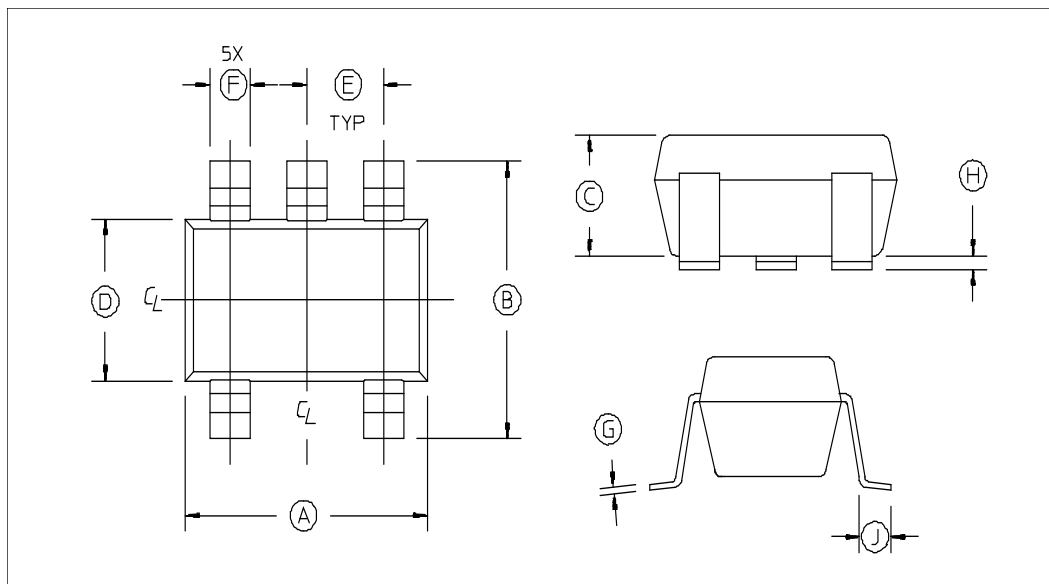

Dim	Inches		Millimeters	
	Min.	Max.	Min.	Max.
A	0.1103	0.1181	2.8	3.1
B	0.1023	0.1181	2.6	3.0
C	0.0355	0.0512	0.9	1.3
D	0.0591	0.0669	1.5	1.7
E	0.0374 REF.		0.95 REF.	
F	0.0138	0.0197	0.35	0.50
G	0.0031	0.0079	0.08	0.20
H	0.0002	0.0059	0.05	0.15
J	0.0138	0.0216	0.35	0.55

MACOM Technology Solutions Inc. ("MACOM"). All rights reserved.

These materials are provided in connection with MACOM's products as a service to its customers and may be used for informational purposes only. Except as provided in its Terms and Conditions of Sale or any separate agreement, MACOM assumes no liability or responsibility whatsoever, including for (i) errors or omissions in these materials; (ii) failure to update these materials; or (iii) conflicts or incompatibilities arising from future changes to specifications and product descriptions, which MACOM may make at any time, without notice. These materials grant no license, express or implied, to any intellectual property rights.

THESE MATERIALS ARE PROVIDED "AS IS" WITH NO WARRANTY OR LIABILITY, EXPRESS OR IMPLIED, RELATING TO SALE AND/OR USE OF MACOM PRODUCTS INCLUDING FITNESS FOR A PARTICULAR PURPOSE, MERCHANTABILITY, INFRINGEMENT OF INTELLECTUAL PROPERTY RIGHT, ACCURACY OR COMPLETENESS, OR SPECIAL, INDIRECT, INCIDENTAL, OR CONSEQUENTIAL DAMAGES WHICH MAY RESULT FROM USE OF THESE MATERIALS.

MACOM products are not intended for use in medical, lifesaving or life sustaining applications. MACOM customers using or selling MACOM products for use in such applications do so at their own risk and agree to fully indemnify MACOM for any damages resulting from such improper use or sale.